

# FINGERPRINT CABINET LOCK

## USER MANUAL

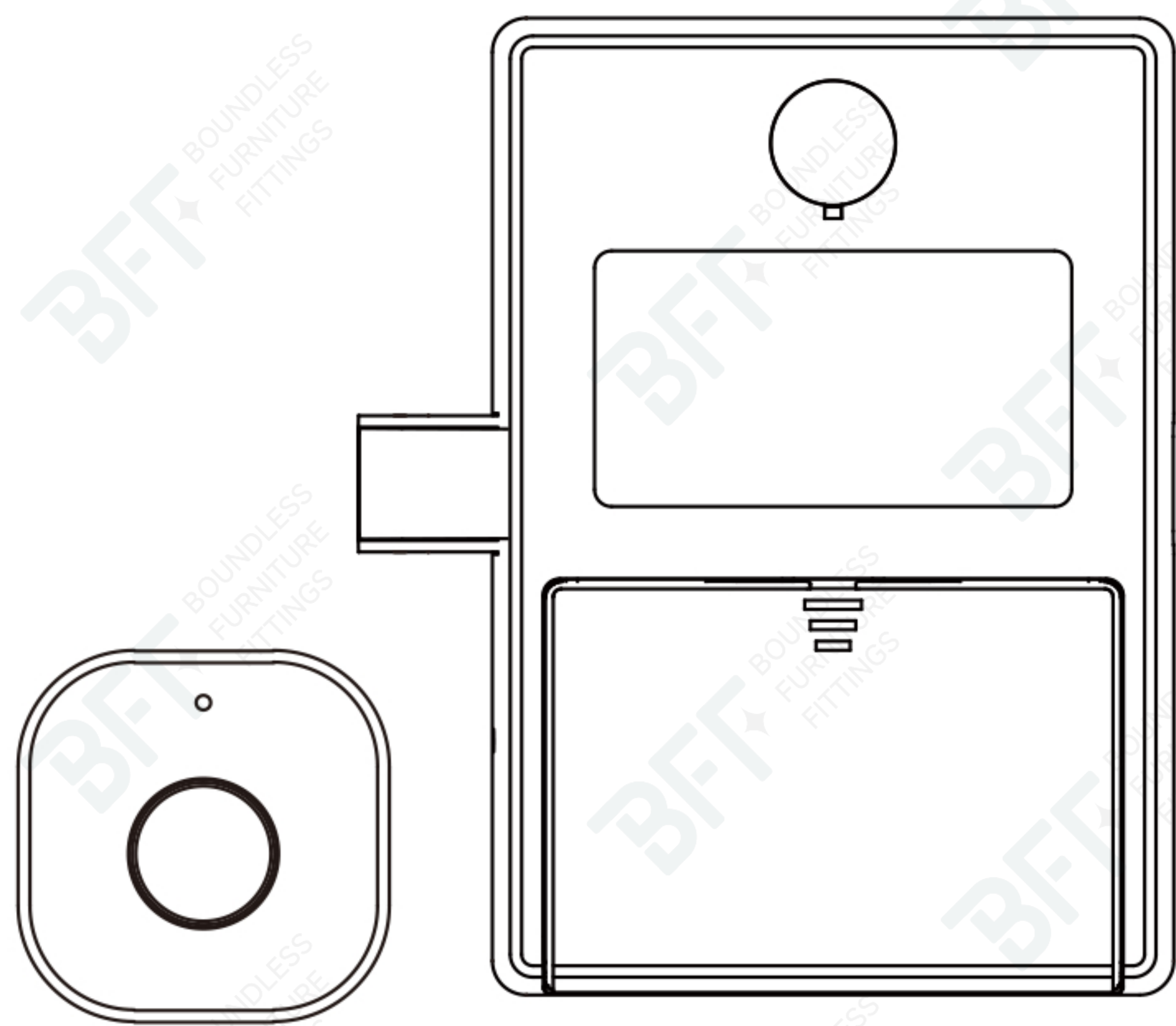

### Feature

- 1. Biometric sensor, high sensitive and rapid responsive
- 2. Max. 10 fingerprints for multiple users
- 3. E-Key for emergency key and management
- 4. ABS panel with elegant design
- 5. Surface mounted, widely used in drawer, cabinet, wardrobe etc.

### Installation Instructions

1. Put the installation drawing on the door, approx. 45mm between the door frame and center hole (Picture 1), then drill the hole

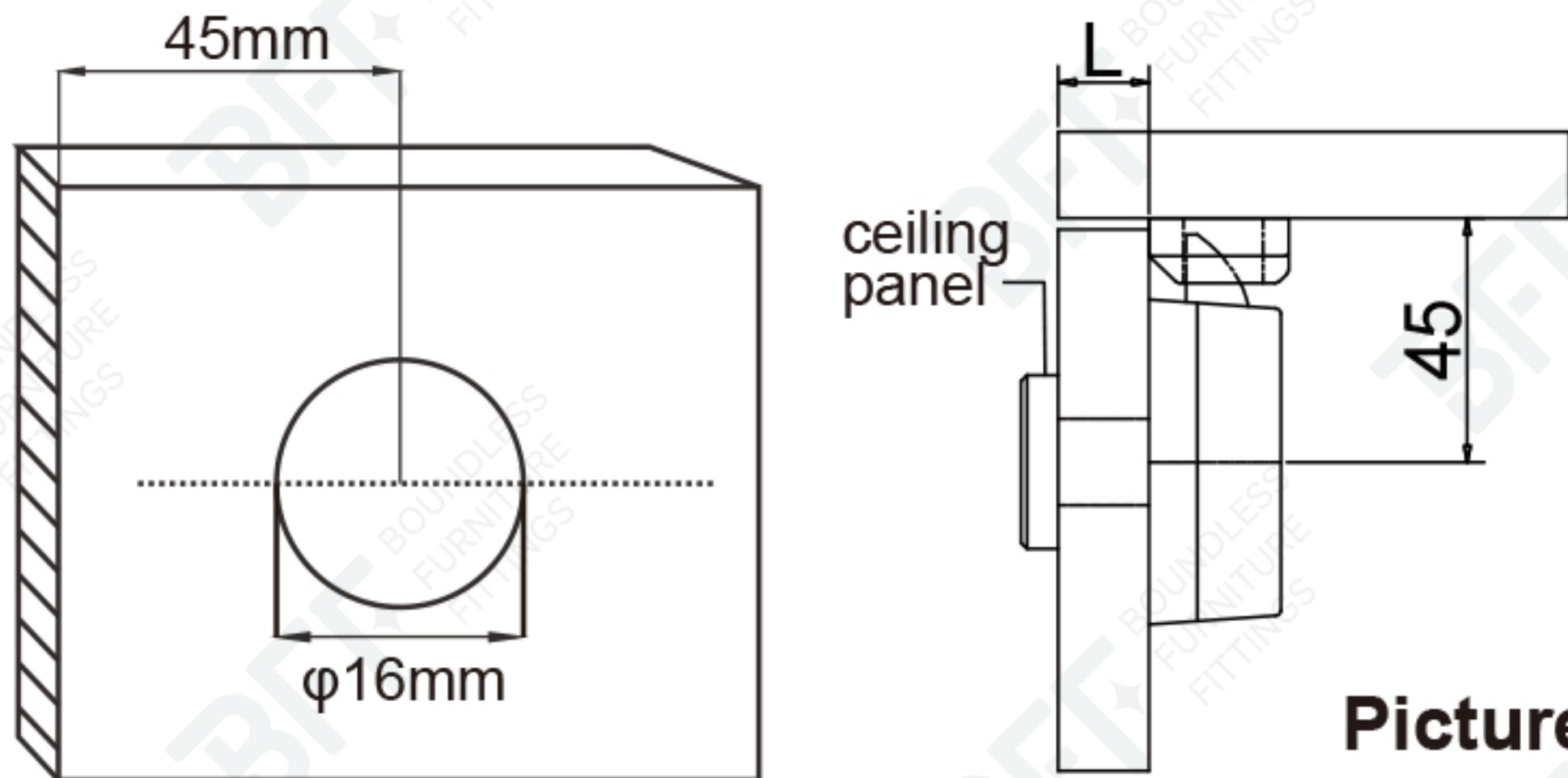

#### wire connection

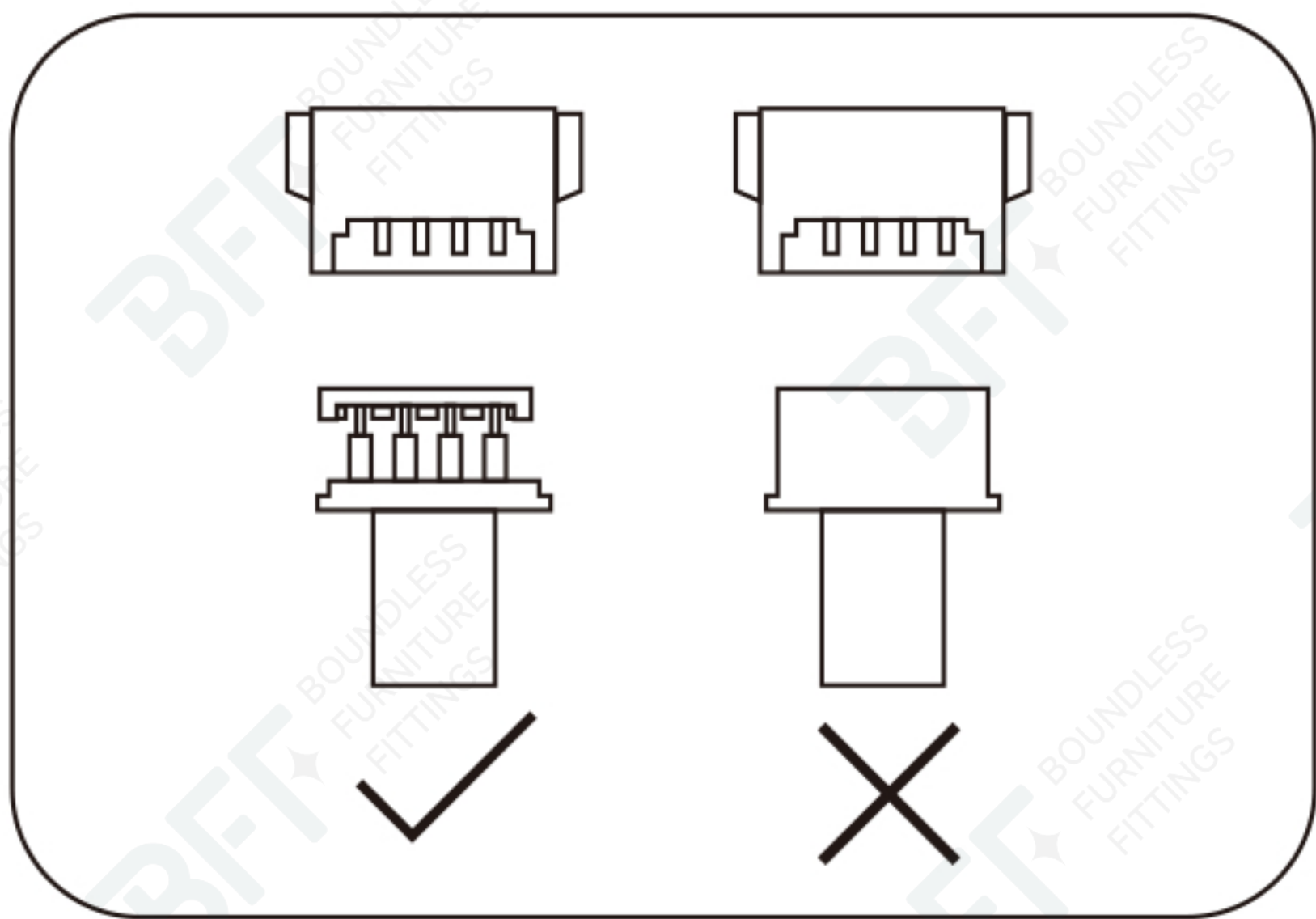

	Door Thickness (mm)	Screw
1	14mm~16mm	ST2.6x10
2	17mm~21mm	ST2.6x14

### Automatic Mode

#### 1. How to add new fingerprints

- Put a registered finger on sensor, green light and latch retracts, holding, green light and latch comes out, keep holding, green light on, then remove
- Blue light, put a finger on, green light then remove
- Put the finger on, green light then remove; repeat until a long green light for 2 seconds (The fingerprint is registered)
- Blue light, add more new fingerprints

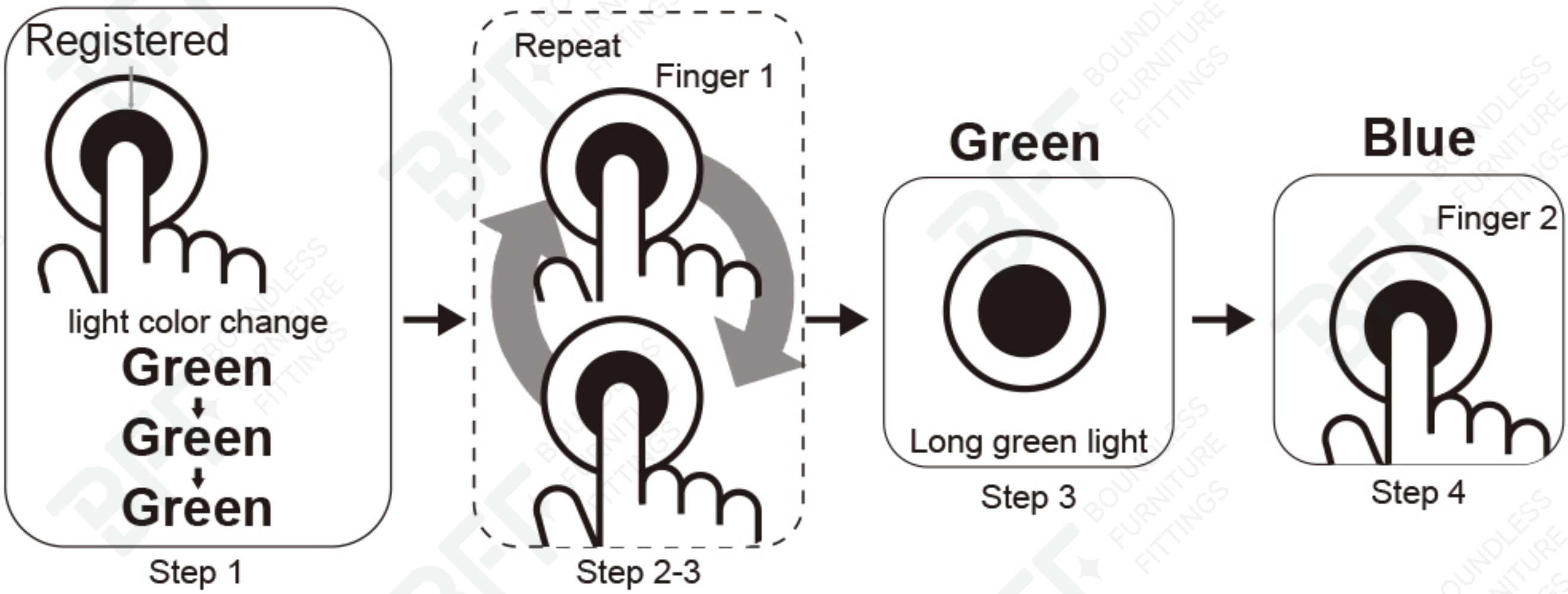

#### Note

- 1). Make sure add the fingerprint before using. Any finger can unlock in the factory setting
- 2) In order to keep the lock work well, to add no less than 3 fingerprints

#### 2. How to lock

- Push the door closed, door lock automatically

#### 3. How to unlock

- Put any registered fingerprint on sensor
- Green light, unlocked
- Pull the door open

- 1) Insert connecting wire (See picture 2) into the front panel, then wire goes through the centre hole; Fix the panel by screw ST2.6X10 and washer
- 2) Fix the washer to the door panel with screws ST3 X10
- 3) Insert connection wire (See Picture 2) into lock case, then fix by screw ST3.5X18MM. Make sure the distance is 45 mm between the centre of back panel and opening wall

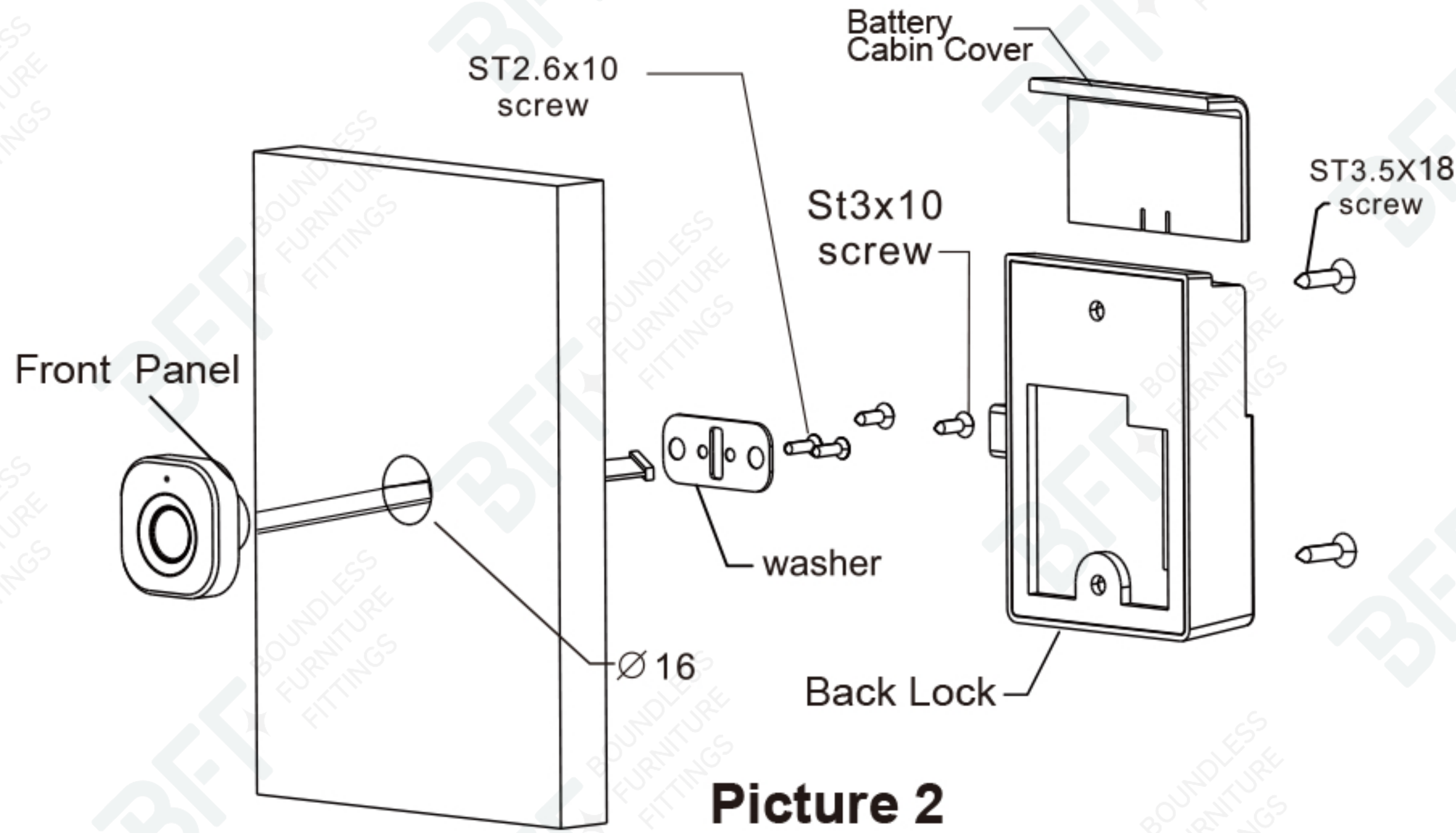

3. Fix the striking plate by screw ST3.5X18 (Make sure latch works well)

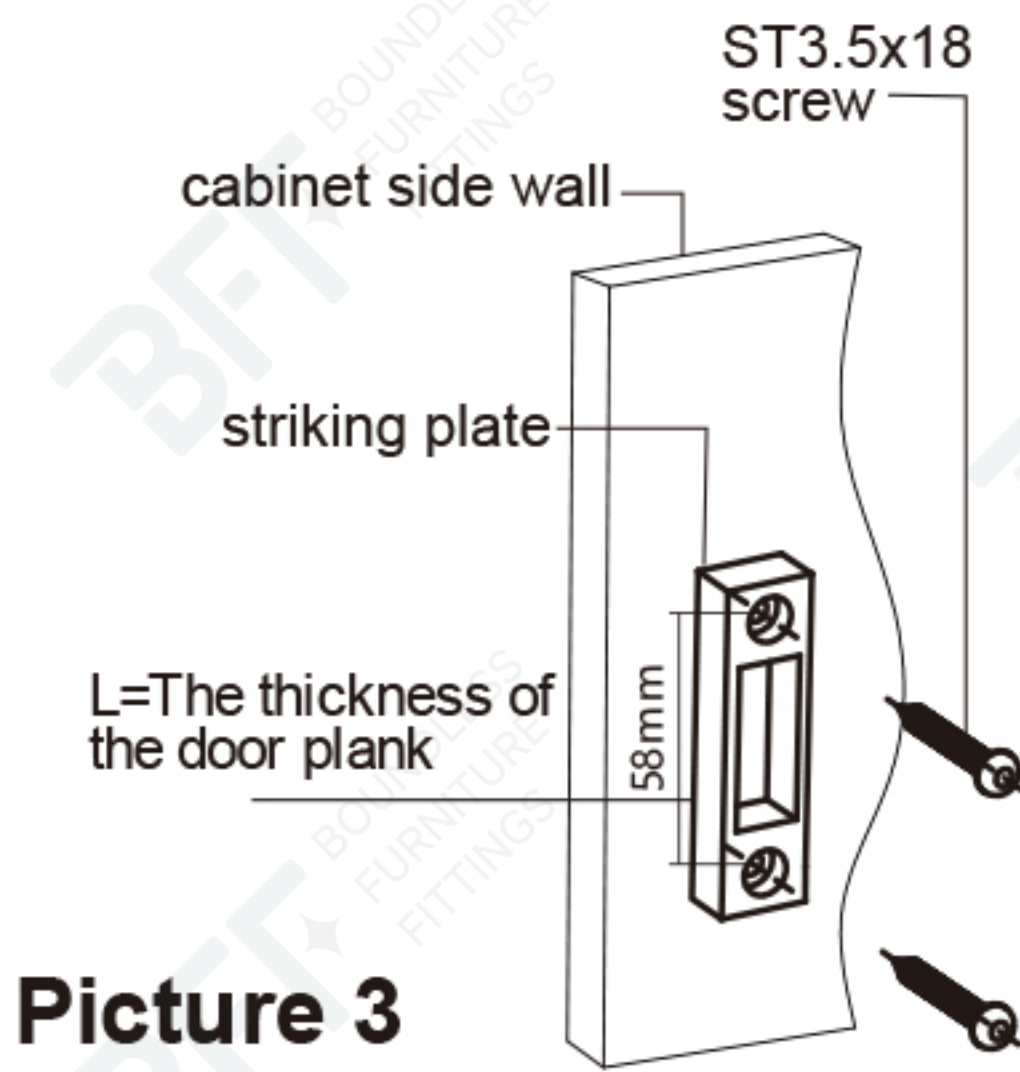

### Other Function

#### 1. How to delete fingerprints

- 1. Insert E-Key
- 2. Put any finger on sensor, green light on, all the fingerprints deleted



#### 2. Low battery warning

- In case of low battery, to put on the registered fingerprint, green light flashes once, and red light flashes twice, then a long green light, unlocked. To change the battery immediately after door open
- Note: Use 3XAAA alkaline battery, not take Carbon battery

#### 3. Outer Power Supply

- When low battery, can connect power bank or mobile plug for outer power supply
- After unlocked, change the battery immediately

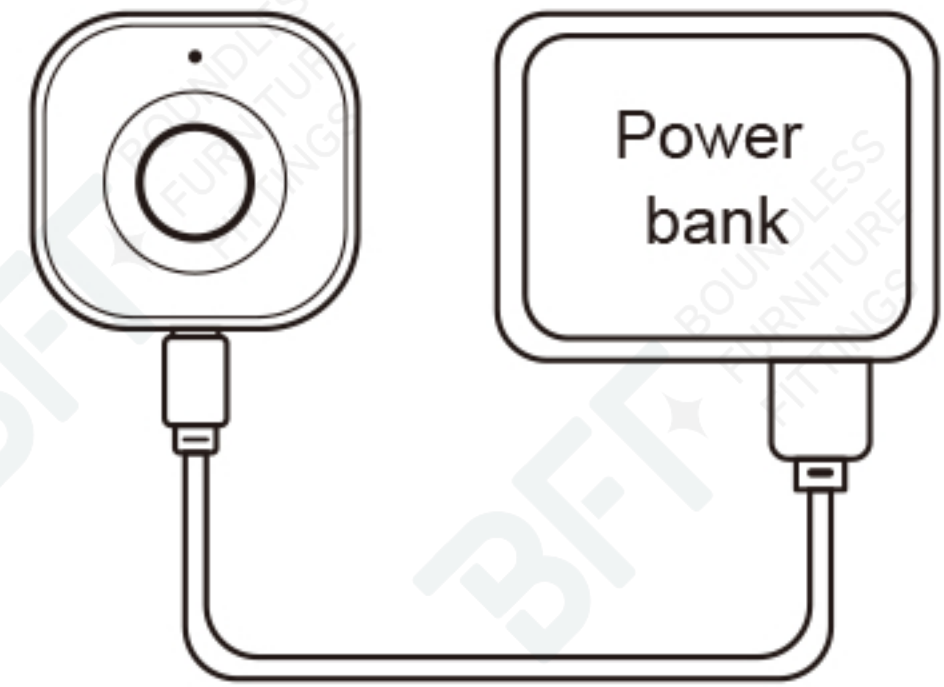

### COMPONENT

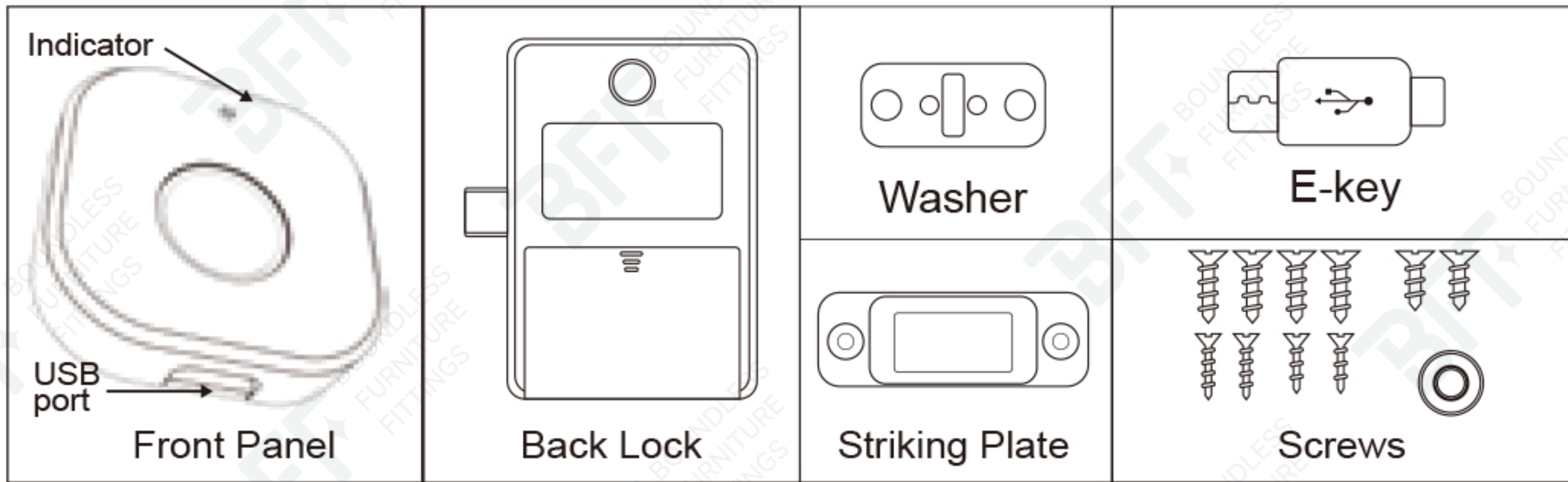

### INSTALLATION DRAWING

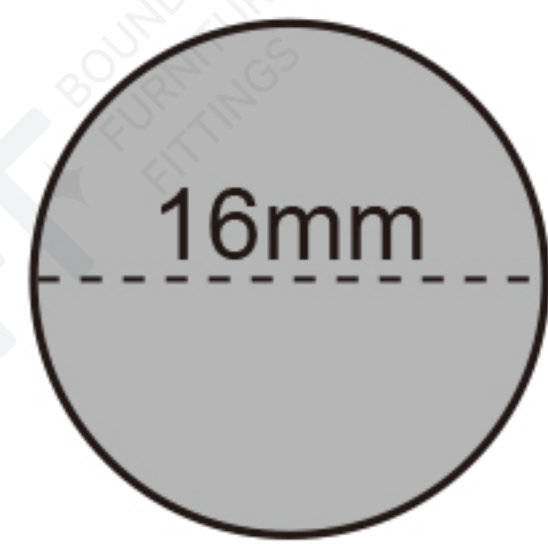

Follow the drawing to drill the hole